

# Tech Tip



*From your friends at New York Bus Sales*

## **Product Effected – Air Brake Units w/Haldex Auto Slack Adjusters**

**Complaint:** *Upon inspection it is observed that there are 2 different slack adjusters on the unit.*

**Cause:** *There was a 3 Phase product change at Haldex on their AAI Style Automatic Slack Adjusters which changed the basic design of the slack adjuster but neither the functional dimensions nor the operation has changed thus these are completely interchangeable with the older style.*

**Correction:** *No correction is required and documentation is attached –*

*As Always should you have questions please do not hesitate to contact us!*

*Thanks To Rich and Paul at Waterville Central School for pointing this out to us!!!*



**Contact Our Service Department With Any Questions**

**CHITTENANGO** – phone 800-962-5768 or

Daryl Wallace : [dwallace@newyorkbussales.com](mailto:dwallace@newyorkbussales.com)

Brian Lamaitis : [blamaitis@newyorkbussales.com](mailto:blamaitis@newyorkbussales.com)

**ROCHESTER** – phone 800-463-3232 or

Gary Chichester: [gchichester@newyorkbussales.com](mailto:gchichester@newyorkbussales.com)

**ALBANY** – phone 866-867-1100 or

Ben Reiling: [breiling@newyorkbussales.com](mailto:breiling@newyorkbussales.com)

Steve Searles: [ssearles@newyorkbussales.com](mailto:ssearles@newyorkbussales.com)

**WARRANTY** – 800-962-5768 ext 237

Morgan Jenkins: [mjenkins@newyorkbussales.com](mailto:mjenkins@newyorkbussales.com)

ALL of our Tech Tips can be found on the New York Bus Sales website at

<http://www.newyorkbussales.com/pages/bulletins.cfm>

Or at the New York Head Mechanic website at

<http://www.nyhma.org/viewforum.php?f=2&start=0>

## AA1 Style Automatic Brake Adjusters Product Change Notice

**This notice is to inform you, as requested by TS16949, that Haldex is making changes to certain part numbers. These changes as described below, are a result of our continuous improvement philosophy and by no means indicate a concern for previously supplied product.**

These changes will be phased in three stages and at each stage a list of affected part numbers will be forwarded.

**Product: Automatic Brake Adjusters:** AA1 style.

**Type of Change:** Global Housing Design.

**Reason for Change:** Need to rationalize tooling resulted in design changes of certain housings.

**Validation of Change:** All housings have undergone extensive testing that exceeds SAE standards.

**Phase 1:** Effective: 12/1/08. Slight visual change in non-functional areas. Does not affect fit, form and function of the product. No part number change.

**Phase 2:** Effective: 2/2/09. Same change as in Phase 1, but with the addition of the relocation of the grease fitting from 30° to 242°. This change is considered in the same location, but different plane. There may be a need to check installation to ensure fit is not affected. Any concerns should be addressed to Haldex for review. Does not affect form and function of the product. No part number change.

**Phase 3:** Effective: 6/1/09. Same changes as in Phase 1 or 2, but with the possibility of housing arm length change. Standard arm hole length ABA's will have a shorter housing arm length. These will have no part number change. Long arm hole length ABA's will have a new housing. These will have a new part number change. As the form will change for both, there may be a need to check installation to ensure fit is not affected. Any concerns should be addressed to Haldex for review.

**Additional Documentation:** Drawings and PPAP documentation are available on request.

**Alternative Change:** For all the changes in Phase 1 & 2 and for the majority of changes in Phase 3 you have the option of specifying our S-ABA product and thus upgrading to the latest ABA technology. S-ABA is available on request.

As always we appreciate your business at Haldex and look forward to supporting your brake system needs in the future. Should you have any questions, or if you would like additional information please contact Paul Chappell (e-mail: paul.chappell@haldex.com; phone: 816-801-2382).

### Haldex Commercial Vehicle Systems

**Haldex Brake Products Corporation**  
10930 N. Pomona Ave.  
Kansas City, MO 64153-1297  
Phone: 816-891-2470  
Fax: 816-891-9447

**Haldex Limited**  
525 Southgate Drive, Unit 1  
Guelph, ON Canada N1G 3W6  
Phone: 519-826-7723  
Fax: 519-826-9497

[www.haldex.com](http://www.haldex.com)

L55256W US 10/08 WEB ONLY

ALL PROPRIETARY RIGHTS IN THE SUBJECT MATTER HEREOF ARE RESERVED AND NO PERMISSION IS GRANTED TO REPRODUCE THIS PRINT IN WHOLE OR IN PART, OR TO DISCLOSE ANY OF THE INFORMATION HEREON TO OTHERS.					
CHANGE NO.	LET.	REVISION	DRN.	APPC.	DATE
96-6024	A	RELEASE FOR PRODUCTION	RDF	RP	5/96
2000-065	B	UPDATE LOGO/ADDRESS	RDF	JSP	1/00

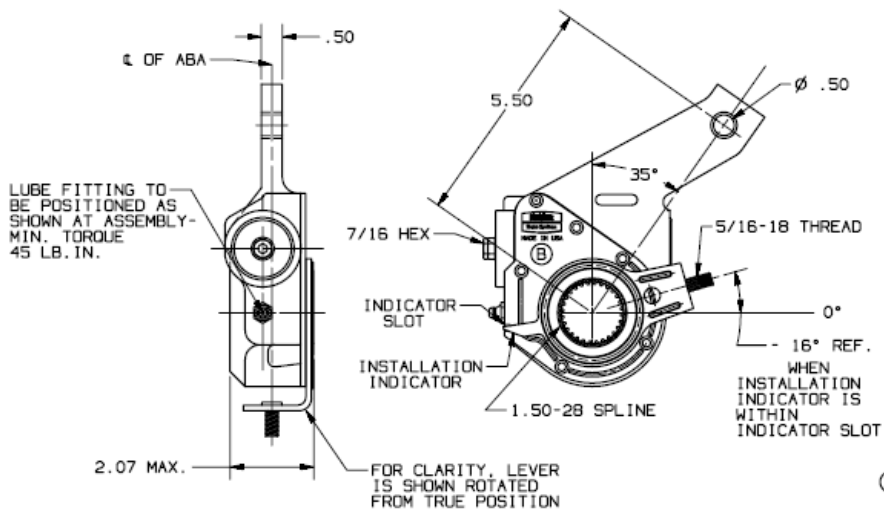

**KCC** KEY CONTROL CHARACTERISTIC  
The key control characteristic symbol identifies those items which define process controls and where statistical applications are mandatory. All other characteristics are to be within defined specifications.

SCALE: NONE  
PROJECTION:

UNLESS OTHERWISE SPECIFIED THE TOLERANCES ARE AS LISTED BELOW

DIM. ARE IN  IN.  MM

.XX = ±.030  
.XXX = ±.005  
ANGLE = ± 1 DEG. BREAK ALL CORNERS

NAME: R. D. FLOWERS  
DATE: 4/2/96

NAME: R. PETRESH  
DATE: 5-14-96

**Haldex Brake Systems**  
Haldex Brake Products Corporation  
Blue Springs Division  
2400 N.E. Caronde Dr.  
Grain Valley, Missouri 64029

NAME: AUTOMATIC BRAKE ADJUSTER COMPLETE  
DRAWING NUMBER: 409-10759

ORIGINAL

ALL PROPRIETARY RIGHTS IN THE SUBJECT MATTER HEREOF ARE RESERVED AND NO PERMISSION IS GRANTED TO REPRODUCE THIS PRINT IN WHOLE OR IN PART, OR TO DISCLOSE ANY OF THE INFORMATION HEREON TO OTHERS.					
CHG. NO.	LET.	REVISION	DRN.	APPC.	DATE
2009-003	C	MOVE TO 475-10296 HOUSING	CK	JSPH/JSP	

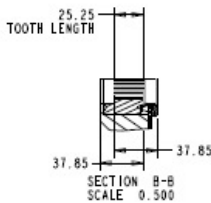
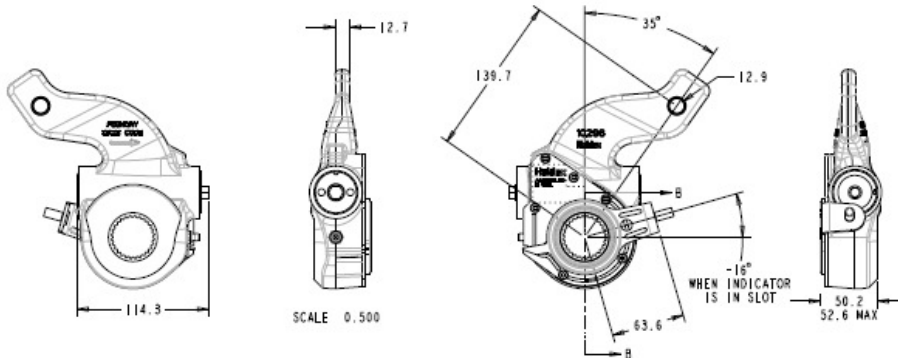
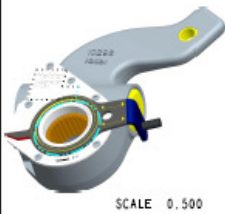

PART/MODEL NUMBER	409-10759
ARM LENGTHS	139.7
CLEVIS PIN BUSHING	12.90
ARM OFFSET	0
BODY INCLINATION	35°
CONTROL ARM TYPE	SINGLE BEND
CONTROL ANGLE	-16°
CONTROL BUSHING	NO
CONTROL STUD	5/16"-18 UNC THD
DISC NOTCH NUMBER	#4
GREASE FITTING TYPE	STRAIGHT
GREASE FITTING LOCATION	180
WORK WHEEL SPLINE	1.50"-28
ADJUSTMENT HEL.	7/16"

RATING OF ADJUSTER (NM) 2260

RAW HOUSING P/N	475-10296
MACH. HOUSING P/N	440-10296
FINAL HOUSING P/N	421-10236

SPECIAL NOTES: ALL DIMENSIONS ARE REFERENCE

APPLICATION: TRACTOR & TRAILER ASSEMBLY

SCALE: NOTED  
PROJECTION:

ALL DIMENSIONS ARE REFERENCE ONLY

NAME: C. KLEINHEXER  
DATE: 6-23-08

NAME: R. D. FLOWERS  
DATE: 4/13/08

NAME: J. S. PATNE  
DATE: 4/13/08

NAME: AUTOMATIC BRAKE ADJUSTER  
DRAWING NUMBER: 409-10759

ANCHOR FASTENER TO BE TIGHTENED ON THE STUD WITH 9 TO 1.4 NM OF TORQUE WHEN INSTALLED.

LUBE FITTING TO BE INSTALLED WITH A MINIMUM TORQUE OF 3.1 NM USING THE STYLE AND LOCATION AS SPECIFIED

SHEET 1 OF 1

UPDATED